

[WWW.FRESHNREBEL.COM](http://WWW.FRESHNREBEL.COM)



FRESH 'N REBEL

**ROCKBOX**

**RAW**

manual

## GET CONNECTED!

1. Fully charge your Rockbox Raw before use.
2. Turn on your Rockbox Raw by switching the On/Off button.
3. Enable Bluetooth on your smartphone or tablet.
4. Select the Rockbox Raw from the list of Bluetooth devices.

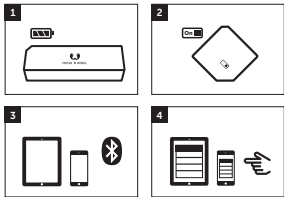

**THE ROCKBOX RAW IS NOW READY  
TO UNLEASH YOUR FAVORITE MUSIC!**

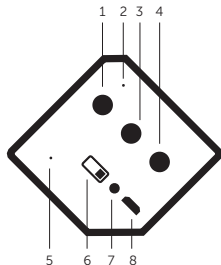

- |                                       |                 |
|---------------------------------------|-----------------|
| 1. Next song /+ volume                | 5. MIC          |
| 2. Bluetooth LED indicator            | 6. Power button |
| 3. Previous song /- volume            | 7. Audio-in     |
| 4. ▶    / press to answer / end calls | 8. Charge       |

## MAAK VERBINDING!

1. Laad je Rockbox Raw volledig op voor gebruik.
2. Schakel je Rockbox Raw in met de aan-uitknop.
3. Schakel Bluetooth in op je smartphone of tablet.
4. Selecteer de Rockbox Raw uit de lijst met Bluetooth-apparaten.

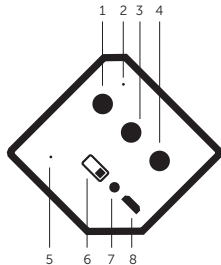
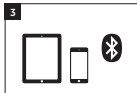
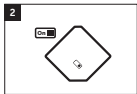
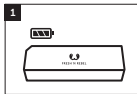

- |  |                 |
|--|-----------------|
| 1. Volgend nummer / + volume                               | 5. Microfoon    |
| 2. Bluetooth LED indicator                                 | 6. Aan-uitknop  |
| 3. Vorig nummer / + volume                                 | 7. Audio-ingang |
| 4. ►    / Druk om oproepen<br>te beantwoorden / beëindigen | 8. Opladen      |

**BEVRIJD JE FAVORIETE MUZIEK!**

## VERBINDUNG HERSTELLEN

1. Laden Sie Ihre Rockbox Raw vor Gebrauch vollständig auf.
2. Schalten Sie Rockbox Raw mit der Ein-/Aus-Taste ein.
3. Aktivieren Sie Bluetooth auf Ihrem Smartphone oder Tablet.
4. Wählen Sie Rockbox Raw aus der Liste der verfügbaren Bluetooth-Geräte aus.

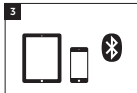
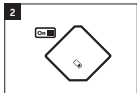
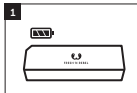

**ROCKBOX RAW IST BEREIT FÜR  
GRENZENLOSEN MUSIKGENUSS!**

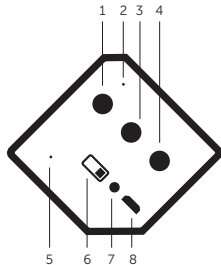

- |  |                    |
|--|--------------------|
| 1. Vorheriger Song / Leiser                | 5. Mikrophon       |
| 2. Bluetooth LED-Anzeige                   | 6. Ein-/ Aus-Taste |
| 3. Nächster Song / Lauter                  | 7. Audioeingang    |
| 4. ▶    / Telefonanrufe annehmen / beenden | 8. Laden           |

## CONNETTITI!

1. Carica completamente Rockbox Raw prima del suo utilizzo.
2. Accendi Rockbox Raw premendo il pulsante di accensione.
3. Abilita il Bluetooth sullo smartphone o sul tablet.
4. Seleziona Rockbox Raw dall'elenco dei dispositivi Bluetooth.

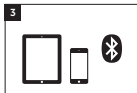
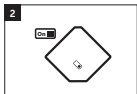
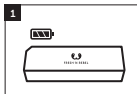

**ROCKBOX RAW È ORA PRONTO A  
SPRIGIONARE TUTTA LA POTENZA  
DELLA TUA MUSICA PREFERITA!**

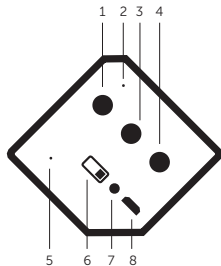

- |  |                           |
|--|---------------------------|
| 1. Brano successivo / + volume                             | 5. Microfono              |
| 2. Indicatore LED Bluetooth                                | 6. Pulsante di accensione |
| 3. Brano precedente / - volume                             | 7. Ingresso audio         |
| 4. ►    / Premere per accettare<br>/ terminare le chiamate | 8. Ricarica               |

## ¡CONÉCTATE!

1. Carga por completo tu Rockbox Raw antes de utilizarlo.
2. Enciende el Rockbox Raw pulsando el botón de alimentación.
3. Activa la función Bluetooth en tu smartphone o tableta.
4. Selecciona el Rockbox Raw de la lista de dispositivos Bluetooth.

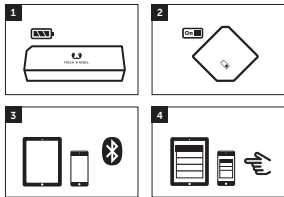

**¡EL ROCKBOX RAW ESTARÁ LISTO PARA QUE DISFRUTES DE TU MÚSICA FAVORITA!**

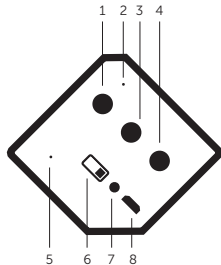

- |   |                          |
|---|--------------------------|
| 1. Siguiete canción / + volumen                       | 5. Micrófono             |
| 2. Indicador LED Bluetooth                            | 6. Botón de alimentación |
| 3. Canción anterior / - volumen                       | 7. Entrada de audio      |
| 4. ►    / Pulsar para responder<br>finalizar llamadas | 8. Carga                 |

## CONNECTEZ-VOUS!

1. Chargez totalement votre Rockbox Raw avant utilisation.
2. Pour allumer votre Rockbox Raw, activez le bouton Marche/Arrêt.
3. Activez la fonction Bluetooth sur votre smartphone ou votre tablette.
4. Sélectionnez le Rockbox Raw dans la liste des périphériques Bluetooth.

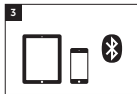
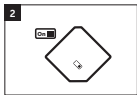
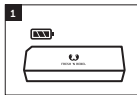

**LE ROCKBOX RAW EST MAINTENANT PRÊT  
À LIBÉRER VOTRE MUSIQUE PRÉFÉRÉE!**

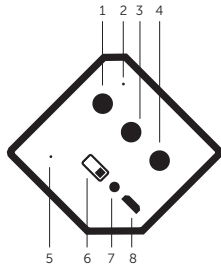

- |   |                          |
|---|--------------------------|
| 1. Morceau suivant / + volume   | 5. Microphone            |
| 2. Témoin lumineux (DEL) Bluetooth                                      | 6. Bouton Marche / Arrêt |
| 3. Morceau précédent / - volume   | 7. Entrée audio          |
| 4. ►    / Appuyez sur ce bouton pour répondre / mettre fin à des appels | 8. Charge                |

## EM CONTACTO!

1. Carregue totalmente a bateria antes de utilizar a sua Rockbox Raw.
2. Ligue a Rockbox Raw no botão de alimentação.
3. Ative o Bluetooth no seu smartphone ou tablet.
4. Selecione Rockbox Raw na lista de dispositivos Bluetooth.

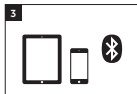
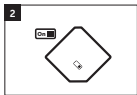
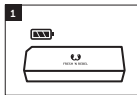

**A ROCKBOX RAW ESTÁ PRONTA  
A DEBITAR AS SUAS MÚSICAS FAVORITAS!**

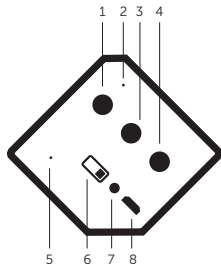

- |  |                         |
|--|-------------------------|
| 1. Música seguinte / + volume                    | 5. Microfone            |
| 2. Indicador LED Bluetooth                       | 6. Botão de alimentação |
| 3. Música anterior / - volume                    | 7. Entrada áudio        |
| 4. ▶    / Prima para atender / terminar chamadas | 8. Carga                |



# EC Declaration of Conformity

Sitecom Europe BV • Linatebaan 101 • 3045 AH • Rotterdam • The Netherlands

We declare under our sole responsibility that the following product:

Product number: 1RB500

Product description: Bluetooth Speaker

Low Voltage Directive (LVD)

- EN 60950-1:2006
  - EN 60950-1:2006/A12:2011
  - EN 60950-1:2006/A1:2010
  - EN 60950-1:2006/A11:2009
- UL 2919

Electromagnetic Fields (EMF)

- EN 62311:2008

Electro-Magnetic Compatibility (EMC) Directive

- ETSI EN 301 489-1 V1.9.2

Radio and Telecom Terminal Equipment Directive (R&TTE)

- EN 300 328 V1.7.1
- EN 300 328 V1.8.1
- ETSI EN 301 489-17 V2.1.1
- ETSI EN 301 489-17 V2.2.1
- ETSI EN 301 489-1 V1.9.2
- EN 301 489-9 v.1.4.1

are fully in conformity with the essential requirements of the relevant EU Directives and other directives as listed below.

Sitecom Europe BV  
Rotterdam, 17-06-2013

M. Bergwerff,



Chief Operations Officer





FRESH 'N REBEL